

### Product Specifications

Product name	Smart Gateway
Battery specifications	DC 5V 1A
Operating temperature	-10°C - 55°C
Operating humidity	10%-90% RH (no condensation)
Wireless connection	ZigBee

### Packing List

- Zigbee smart gateway x 1
- DC5V power supply x 1 (Optional matching)
- Network cable x 1
- Instruction manual x 1
- Power cable x 1

Please read the instruction manual carefully before using the product

### Electronic Information Products Toxic And Hazardous Substances Declaration

Part name	Toxic or harmful substances or elements				
	Lead Pb	Mercury Hg	Cadmium Cd	Hexavalent chromium Cr (VI)	Polybrominated biphenyl PBB
PCB board	○	○	○	○	○
Housing	○	○	○	○	○
Cable	○	○	○	○	○

○: Indicates that the content of this toxic and hazardous substance in all homogeneous materials of this part is below the maximum limit specified in SJ/T1163-2006 Requirements for Concentration Limits for Certain Hazardous Substances in Electronic Information Products;  
 X: Indicates that the toxic or hazardous substance contained in at least one of the homogeneous materials of the part exceeds the maximum limit specified in the SJ/T1163-2006 standard.

10: The figures in this label indicate that the product has an environmental protection use period of 10 years under conditions of normal use, and some parts may also have an environmentally friendly use period mark. The environmental protection use period is based on the number indicated by the mark.

### Product Description

This smart gateway is the control center for Zigbee compatible devices. It connects to the app for adding, reset of Zigbee compatible devices, third-party control, and Zigbee group control. Users can design and implement smart home scenarios by adding Zigbee devices through the gateway.

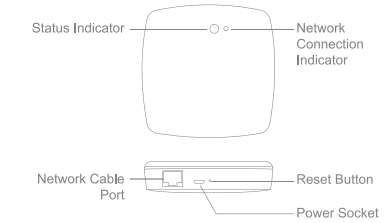

### Preparation For Use

- ① Mobile phone is connected to Wi-Fi



Ensure that the smart phone is within the same Wi-Fi network of the Smart Gateway to ensure an effective connection between the smart phone and the Smart Gateway.

### Preparation For Use

- ② Download and open the App

Sensbi app is available for both iOS and Android OS. Search the name 'SENSBI' in App Store or Google Play.

Sensbi app controls all of your smart products!

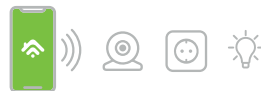

If you are downloading the App for the first time, please tap "Register" to register your account. If you already have an account, please click the "Login" button.

### Network Settings

- Connect the gateway to the power supply and connect it to the home 2.4GHz band router through the cable, please connect power to gateway first, if power LED is on, then connect network cable, please confirm two LED are on, then go to the next step;
- Make sure that the mobile phone is connected to the home 2.4GHz band router. At this time, the mobile phone and the gateway are in the same local area network;
- Open the "My Home" page of the App and click the "+" button on the upper right corner of the screen;
- "Gateway" will appear on the "Gateway Control" page, click it for adding device;
- Then follow the App's instructions to finish adding device;

### Add Device

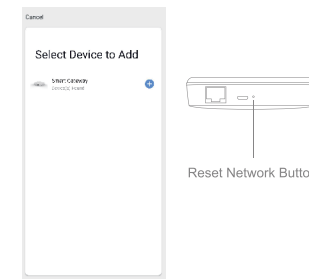

- Once the device has been added successfully, you will be able to find the device on the "My Home" page.

HUBI-WD  
Zigbee Gateway

QUICK  
GUIDE